

TAKSTAR® 得胜



WPM-700 | 无线监听系统
Wireless Monitor System

使用手册 | User Manual

■ 前言

尊敬的用户：

感谢您选购得胜WPM-700无线监听系统,为了您能够更好地了解使用本产品,建议您在使用前仔细阅读本使用手册。

若存在有疑问或者您有宝贵的建议,可通过拨打得胜官方服务热线400 6828 333或微信扫描二维码关注得胜官方公众号与我们联系。



■ 产品特性

- 专为直播监听、乐器监听、舞台监听等场合设计的无线监听系统；
- 采用UHF调频, GFSK调制, 抗干扰性强, 稳定低功耗；
- 系统具备31个频道, 可同时配多套设备同时工作；
- 在无干扰、无障碍物的环境下传输距离可达100米以上；
- 失真率小于0.1%, 精准还原音频信号, 确保高质量监听效果；
- 红外对频方式, 一键完成发射器与接收器频道同步, 方便快捷；
- 发射器内置锂电池, 续航时间12小时以上, 方便移动场景监听应用；
- 发射器配备本地监听接口, 便于本地音频信号的实时监听；
- 接收器配备线性输出接口, 方便连接调音台、音响等外接音频设备。

■ 适用范围

适用直播监听、乐器监听、舞台监听、同声翻译等场合。

■ 产品配置

WPM-700套装

接收器.....	1个
发射器.....	1台
天线.....	1支
3.5mm音频线.....	1条
6.35mm转换插头.....	1个
5号干电池.....	2节
充电线.....	1条
使用手册.....	1份

WPM-700R单接收

接收器.....	1个
5号干电池.....	2节
使用手册.....	1份

■ 技术参数

综合参数

- 载波频率范围:640-664MHz
- 调制方式:GFSK
- 最大功率:80mW
- 综合THD:<0.1%
- 信噪比:65dB
- 低/高功率续航时间:15/12 H
- 输出输入接口:3.5mm
- 无线频道数:31个
- 频响范围:20-20kHz
- 额定功率:50mW
- 分离度:75dB
- 动态范围:95dB
- 低/高功率传输范围:100/150米(空旷地带)

发射器

- 低/高发射功率:11/16 dBm
- 低/高工作电流:130/180±20mA
- 电池规格:3.7V/2000mAh
- 充电方式:USB 5V/1A

接收器

- 灵敏度:<-95dB
- 电池规格:DC 1.5V/AA两节电池
- 低/高工作电流:250mA±20mA

注:以上数据由得胜实验室测试得到,并拥有最终解释权!

■ 功能示意

发射器

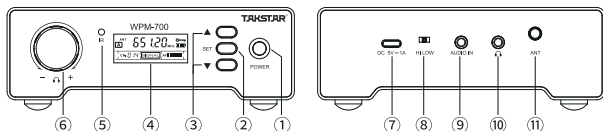

- ① 电源按键:长按2秒开机或关机。
- ② SET键:点按进入红外对频模式,详见对频方法部分。
- ③ ▲/▼键:点按调节频道(CH00-CH30频道循环),长按快速调频;同时长按▲键和▼键2秒可锁定和解锁▲、▼、SET按键调频功能。
- ④ LED显示屏:显示当前频段、电量、通道、输入信号等信息。
- ⑤ IR红外窗口:完成发射器与接收器频率同步。
- ⑥ 监听音量控制旋钮:顺时针旋转增大音量;逆时针旋转减小音量。
- ⑦ Type-C充电接口:连接5V/1A以上适配器充电。
- ⑧ 高低功率切换开关:拨至“HI”为高功率模式;拨至“LOW”为低功率模式。
- ⑨ AUDIO IN接口:3.5mm音频输入,连接音源设备如声卡等。
- ⑩ 监听接口:接入耳机设备进行声音监听。
- ⑪ 天线连接座:将标配的天线旋入连接座中。

发射器显示屏

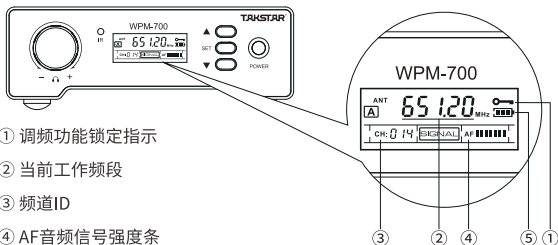

- ① 调频功能锁定指示
- ② 当前工作频段
- ③ 频道ID
- ④ AF音频信号强度条
- ⑤ 电池电量显示

- 充电时, 电量符号呈流水跑马灯显示;
- 充满后, 电量显示满格。

接收器

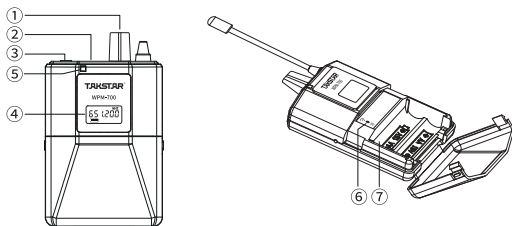

- ① 开关&音量旋钮: 顺时针旋转为开机和增大音量; 逆时针旋转为减小音量至关机。
- ② LINE线性输出接口: 接入音响或其他音频处理设备。
- ③ 耳机监听接口: 接入监听耳机。
- ④ 显示屏: 显示当前工作频率和电池电量信息。
- ⑤ 信号指示灯: 对频成功, 绿灯常亮; 未对频时, 指示灯熄灭。
- ⑥ IR红外窗口: 完成接收器与发射器频率同步。
- ⑦ 电池仓: 将两节1.5V AA电池按照正负极装入电池仓内。

■ 使用说明

对频方法

产品出厂时已默认配对好,开机会自动连接,无需配对。如遇有信号干扰,可按下面方法进行调频并对频同步。

1. 首先将发射器和接收器开机;
2. 按发射器上的▲/▼键调节频道后,点按SET键,进入IR---对频模式,此时IR窗口快闪;
3. 打开接收器电池仓盖,将接收器与发射器的红外窗口对准3秒后完成对频;
4. 对频成功后,接收器绿灯常亮,屏幕同步显示频段;
5. 如需一拖多,在保持发射器频道不变下,继续点按SET键,依次完成所有接收器的对频即可。

注:对频成功后,设备自动记忆对频信息,下次开机无需重复操作。

锁定和解锁

同时长按▲键和▼键2秒可锁定▲、▼、SET 按键调频功能,避免误操作频率不同步,再次同时长按▲键和▼键2秒可解锁调频功能。

■ 安全警示

为避免电击、高温、着火、辐射、爆炸、机械危险以及使用不当等可能造成的人身伤害或财产损失，使用本产品前，请仔细阅读并遵守以下事项：

1. 使用产品时请确认所连设备与本产品是否匹配以及合理调整音量大小，不要在超过产品功率及大音量下长时间使用，以免造成产品异常；
2. 使用中若发现有异常（如冒烟、异味等），请立即关闭电源开关并拔掉电源插头，然后将产品送售后服务网点检修；
3. 消费者若使用电源适配器供电，则应购买配套使用获得CCC认证并满足标准要求的电源适配器；
4. 本产品及配件都应放置在室内干燥通风处，请勿长期存放在潮湿、灰尘多的环境，使用中避免靠近火源、雨淋、进水、过度碰撞、抛掷、振动本机及覆盖通风孔，以免损坏其功能；
5. 若产品需要固定于墙壁或天花板时，请确保固定到位，防止因固定强度不足导致产品发生跌落危险；
6. 使用该产品时需遵守相关安全规定，法律法规明确禁止使用场合请勿使用本产品，以免导致意外事故；
7. 请不要自行拆机改装或维修，以防止出现人身伤害，如有问题或服务需求请联系当地售后服务网点跟进处理。

■ 环保说明

产品中有毒有害物质或元素的名称及含量标识表

部件名称	有毒有害物质或元素									
	铅 (Pb)	汞 (Hg)	镉 (Cd)	六价铬 (Cr(VI))	多溴联苯 (PBB)	多溴二苯醚 (PBDE)	邻苯二甲酸 二正丁酯 (DBP)	邻苯二甲酸 二异丁酯 (DIBP)	邻苯二甲酸 丁基酯 (BBP)	邻苯二甲酸 二(2-乙基)己酯 (DEHP)
塑料部件	○	○	○	○	○	○	○	○	○	○
金属部件	×	○	○	○	○	○	○	○	○	○
电路板组件	×	○	○	○	○	○	○	○	○	○
线缆	×	○	○	○	○	○	○	○	○	○

本表格依据SJ/T 11364的规定编制。

○ : 表示该有害物质在该部件所有均质材料中的含量均在 GB/T 26572 规定的限量要求以下。

× : 表示该有害物质至少在该部件的某一均质材料中的含量超出 GB/T 26572 规定的限量要求。

此标志为产品的环保使用期限标志，
且此环保使用期限只适用于产品正常工作的温度和湿度等条件。

电池部份的环保使用期限为5年。





■ 关于图标含义解释



此符号表示，根据WEEE指令(2012/19/EU)和国家法律，由于这种类型的废弃物会有潜在的有害物质，可能对环境 and 人类健康产生负面影响，所以本产品不应与您的家庭垃圾一起处置，应将本产品交由授权的电气和电子设备 (WEEE) 回收站回收。同时，您在正确处理本产品的同时将有助于自然资源的有效利用。如需了解更多有关您可以在何处放置废物回收设备的信息，请联系您当地的城市办事处、废物管理局或家庭废物处理服务部门。

■ 关于本说明书

本使用手册中内容符合截止印刷之日的技术规格。由于得胜公司会不断改进产品,本使用手册可能不符合您的特定产品的技术规格。要获取最新版使用手册,请访问得胜官网,然后下载使用手册文件。技术规格、设备或另售的附件在各个地区可能有所不同,如有问题请与当地得胜销售网点确认。如需更多支持和深层产品信息,请浏览得胜官方网站:<https://www.takstar.com>

版权所有 ©2025 得胜。得胜、TAKSTAR及其各自标志是得胜公司在中国和/或其他国家/地区的注册商标或商标。所有其它商标均是其各自所有者的财产。

■ Preface

Dear Customer,

Thank you for purchasing our product. Read this manual thoroughly to use the product properly.

If you have any questions or suggestions, please contact our local sales service.

■ Features

- Designed for livestream, instrument, and stage monitoring, as well as simultaneous interpretation.
- UHF modulation with GFSK ensures strong interference resistance and low power consumption.
- Supports 31 channels for simultaneous operation of multiple systems.
- Transmission range exceeds 100 meters in unobstructed environments.
- Distortion rate under 0.1% guarantees high-quality audio reproduction.
- One-button infrared sync for quick transmitter-receiver channel matching.
- Built-in lithium-ion battery in transmitter for over 12 hours of runtime.
- Local monitoring interface on transmitter for real-time audio checks.
- Line output on receiver for easy connection to mixers and external audio devices.

■ Applications

For livestream, instrument, and stage monitoring, as well as simultaneous interpretation.

■ Package

WPM-700 Set

- 1 × Receiver
- 1 × Transmitter
- 1 × Antenna
- 1 × 3.5mm Audio Cable
- 1 × 6.35mm Adapter
- 2 × AA Battery
- 1 × Charging Cable
- 1 × User Manual

WPM-700R Receiver

- 1 × Receiver
- 2 × AA Battery
- 1 × User Manual

■ Specifications

Overall System

- Carrier Frequency Range: 640-664MHz
- Number of Wireless Channels: 31
- Modulation Type: GFSK
- Frequency Response: 20-20kHz
- Maximum Power: 80mW
- Rated Power: 50mW
- Total Harmonic Distortion (THD): <0.1%
- Separation: 75dB
- Signal-to-Noise Ratio (SNR): 65dB
- Dynamic Range: 95dB
- Low/High Power Battery Life: 15/12 hours
- Low/High Power Transmission Range: 100/150 meters (open area)
- Input/Output Interface: 3.5mm

Transmitter

- Low/High Transmission Power: 11/16dBm
- Low/High Operating Current: 130/180 ± 20mA
- Battery Spec: 3.7V/2000mAh
- Charging Method: USB 5V/1A

Receiver

- Sensitivity: <-95 dB
- Battery Spec: Two DC 1.5V AA batteries
- Low/High Operating Current: 250 mA ± 20mA

Note: The above data are measured by Takstar laboratory which has the final interpretation right!

Function Descriptions

Transmitter

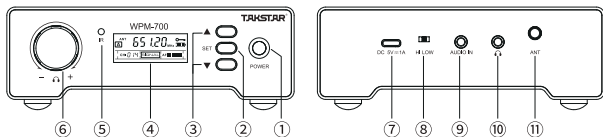

- ① Power Button: Press and hold for 2 seconds to power on or off.
- ② SET Button: Press to enter infrared sync mode; refer to the sync section for details.
- ③ ▲/▼ Buttons: Press to adjust channels (CH00-CH30 in a loop); press and hold for fast adjustment. Press and hold both ▲ and ▼ for 2 seconds to lock or unlock frequency adjustment function.

WPM-700 Wireless Monitor System

- ④ LED Display: Shows current frequency, battery level, channel, and input signal info.
- ⑤ IR Window: Used for frequency sync between transmitter and receiver.
- ⑥ Monitor Volume Knob: Rotate clockwise to increase volume, and vice versa.
- ⑦ USB-C Charging Port: Connect to a 5V/1A or higher adapter for charging.
- ⑧ Power Mode Switch: Set to HI for high power mode; set to LOW for low power mode.
- ⑨ AUDIO IN Port: 3.5mm audio input for connecting source devices like audio interfaces.
- ⑩ Monitoring Port: Connect headphones for audio monitoring.
- ⑪ Antenna Connector: Screw in the included antenna to the connector.

Transmitter Display

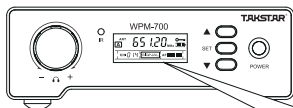

- ① Frequency Lock Indicator
- ② Current Operating Frequency
- ③ Frequency Channel ID
- ④ AF Audio Signal Strength Meter
- ⑤ Battery Level Indicator

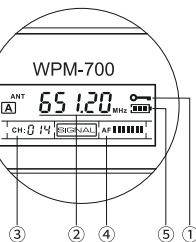

- Running meter while charging.
- Full meter when fully charged.

Receiver

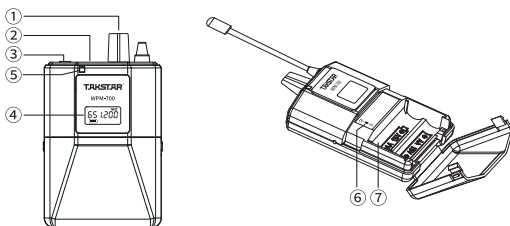

- ① Power & Volume Knob: Rotate clockwise to power on and increase volume; rotate counterclockwise to decrease volume and eventually power off.
- ② LINE Output Port: Connects to speakers or other audio processing devices.
- ③ Headphone Monitoring Port: Connect headphones for audio monitoring.
- ④ Display: Shows current operating frequency and battery level info.
- ⑤ Signal Indicator Light: Green light indicates successful sync; light is off when not synced.
- ⑥ IR Window: Used for frequency sync between the receiver and transmitter.
- ⑦ Battery Compartment: Insert two 1.5V AA batteries according to polarity markings.

■ Operating Instructions

Frequency Sync

The product is pre-paired upon leaving the factory and will automatically connect when powered on. If you experience signal interference, follow the steps below to adjust the frequency and sync.

1. Power on both the transmitter and receiver.
2. Use the ▲/▼ buttons on the transmitter to adjust the channel, then press the SET button to enter IR sync mode; the IR window will blink rapidly.

WPM-700 Wireless Monitor System

3. Open the battery compartment cover of the receiver and align the IR windows of the transmitter and receiver for 3 seconds to complete sync.
4. Once sync is successful, the green light on the receiver will remain on, and the display will show the synced frequency.
5. To connect multiple receivers, keep the transmitter channel unchanged and continue the above process, press the SET button to sync each receiver sequentially.

Note: After successful sync, the device will automatically remember the pairing info, and you will not need to repeat the process during the next power-up.

Locking and Unlocking

Simultaneously press and hold the ▲ and ▼ buttons for 2 seconds to lock the frequency adjustment function to prevent accidental operation. Press and hold the ▲ and ▼ buttons for 2 seconds again to unlock.

■ Safety Instructions

To avoid electric shock, overheat, fire, radiation, explosion, mechanical risk and injury or property loss due to improper use, please read and observe the following items before use:

1. Please check if the power of the connected equipment matches with that of this product before operation. Adjust the volume to proper level during operation. Do not operate at over-power or high-volume level for extended time to avoid product malfunction.
2. If there is any abnormality during use (e.g., smoke, strange odor), please kill the power switch and unplug from power source, then send the product to the local after-sales service for repair.
3. Power adapter used, if any, should be approved by CCC certification or similar standards and comply with the power supply requirements.
4. Keep this product and its accessories in a dry and ventilated area. Do not store in a humid or dusty area for extended time. Keep away from fire, rain, liquid intrusion, bumping, throwing, vibrating, or from blocking any ventilation openings, to prevent malfunction.
5. The product must, when installed on walls or ceilings, be fixed firmly in place at adequate strength to prevent from falling.
6. Please abide by safety rules during operation. Do not use the product in places prohibited by laws or regulations to avoid accident.
7. Do not disassemble or repair the product unauthorized to avoid injury. If you have any questions or require any services, please contact our local after-sales service.

■ Label Meanings



This symbol indicates that this product should not be disposed of with your household waste, according to the WEEE directive (2012/19/EU) and your national law. This product should be handed over to an authorized collection site for recycling waste electrical and electronic equipment (WEEE). Improper handling of this type of waste could have a possible negative impact on the environment and human health due to potentially hazardous substances that are generally associated with WEEE. At the same time, your cooperation in the correct disposal of this product will contribute to the effective usage of natural resources. For more information about where you can drop off your waste equipment for recycling, please contact your local city office, waste authority, or your household waste disposal service.

■ About This Manual

This manual contains up-to-date technical specifications as of printing. However, specifications contained herein may not conform to your particular product since Takstar is constantly improving its products. Also, specifications, devices or accessories available may vary from region to region. If you have any questions, please contact our local sales outlet. For the latest version/more information, please visit our website: <https://www.takstar.com/>
Copyright ©2025 TAKSTAR. TAKSTAR, 得胜 and their respective logos are registered trademarks or trademarks of Takstar company in the PRC, and/or other countries. All other trademarks are the property of their respective owners.

注意事项:

1. 本单为保修凭证, 请用户妥善保管, 如有遗失, 恕不保修或退换。
2. 保修期限制: 购买之日起十二个月内。
3. 除了不可抗力事件损坏外, 由本公司负责, 免费维修。
4. 如属保管不善或使用不当造成的损坏, 维修点将酌情收费。
5. 擅自拆卸维修者, 不予保修。
6. 以上保修条款仅限于中国市场适用 (不含港澳台地区)。

产品服务保证书

姓名: _____ 电话: _____ 地址: _____

商品: _____ 型号: _____ 购买日期: _____ 年 _____ 月 _____ 日

维修记录栏 (由维修员填写)	维修员签名	日期

◆ 广东得胜电子有限公司 ◆ 电话: 400-6828-333 ◆ 地址: 广东省惠州市博罗县龙溪街道盖康一路2号



扫一扫，了解更多产品
Scan for more
product information

广东省电声工程技术研究开发中心 广东得胜电子有限公司制造

地址：广东省惠州市博罗县龙溪街道富康一路2号

服务热线：400 6828 333 传真：0752 6383950

邮箱：xs@takstar.com

网址：www.takstar.com

Guangdong Takstar Electronic Co., Ltd.

Address: No. 2 Fu Kang Yi Rd., Longxi Boluo

Huizhou, Guangdong 516121 China

Tel: 86 752 6383644 Fax: 86 752 6383952

Email: sales@takstar.com

Website: www.takstar.com